

950Q

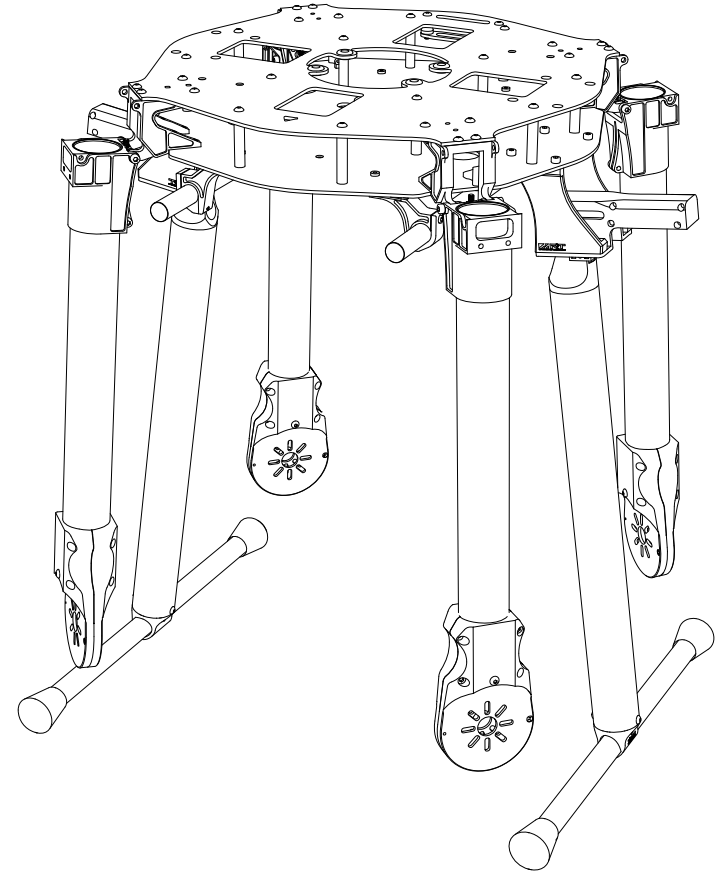

950Q

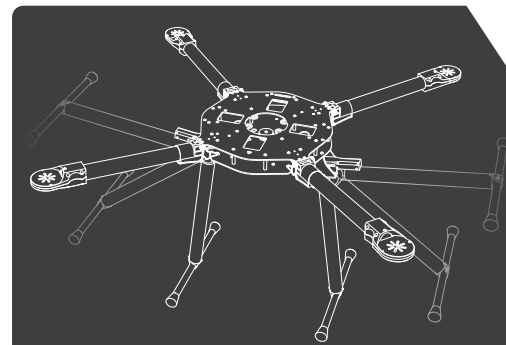

**SPEC:**  
Diagonal Wheelbase:950mm  
MAX.Prop.18 inch  
Total weight:1900 g  $\pm$ 3%

**1** Please install the frame posts to the upper-frame as the figure shows.  
將鋁柱如圖組裝於機身上板。

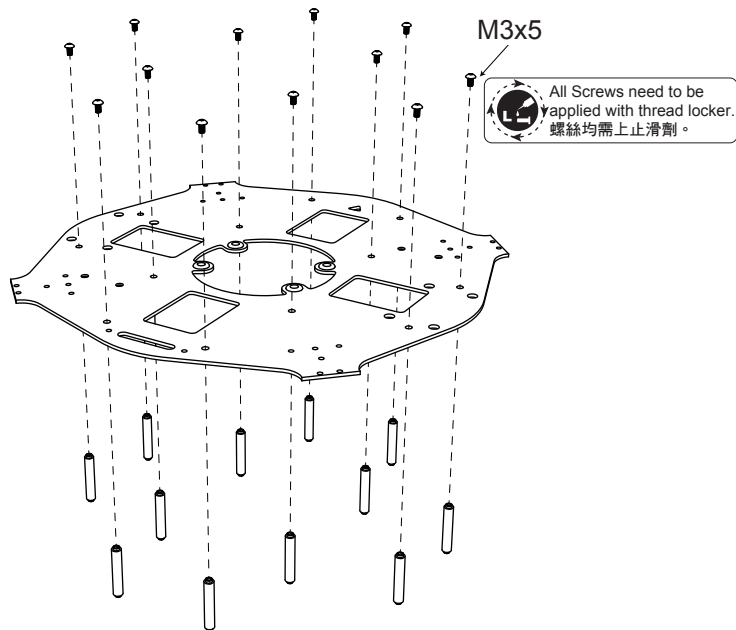

**2** Please install "boom mount" to the frame as the figure shows.  
將管夾座如圖鎖至機身。

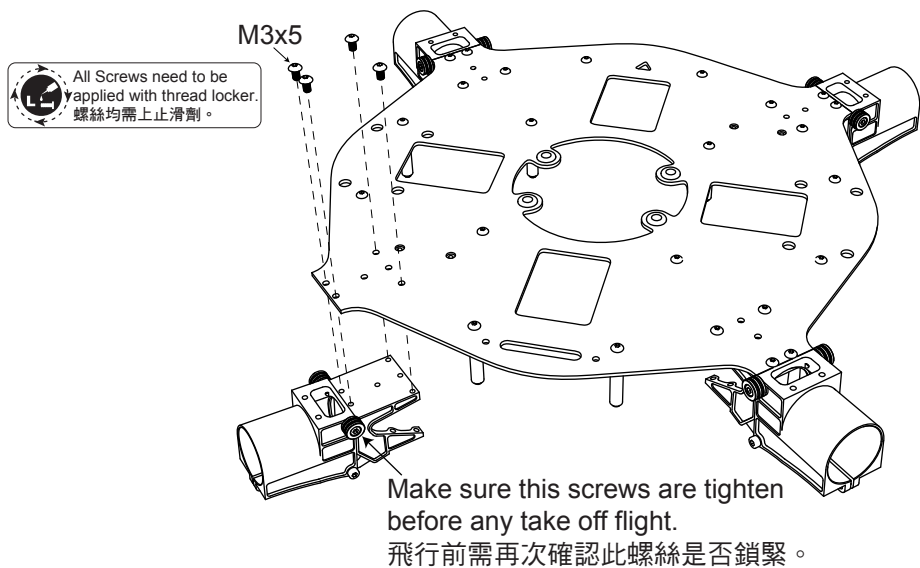

**3** Install down-frame as the figure shows.  
將機身下板如下圖組裝。

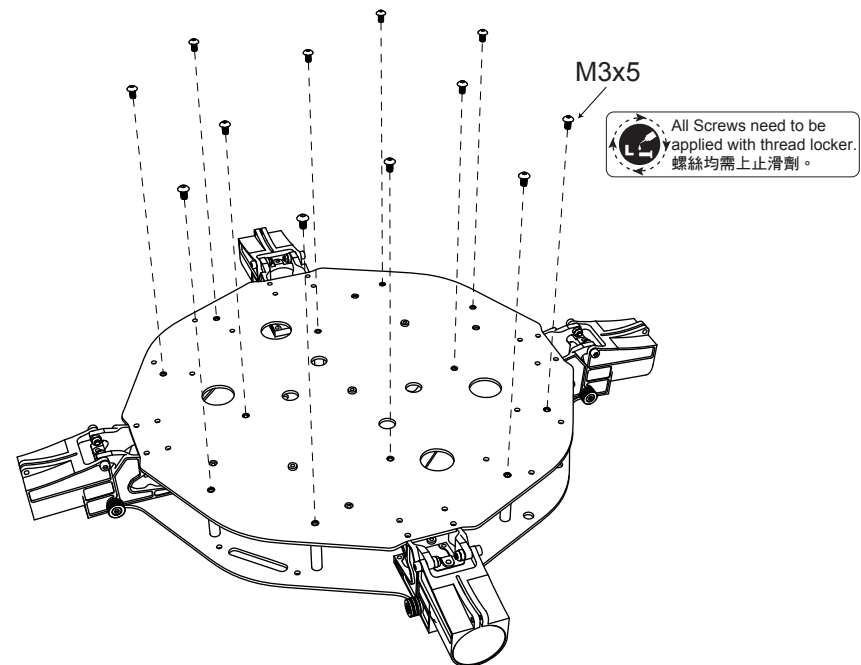

**4** Tighten the screws as figure shows.  
將機身組如圖鎖上螺絲。

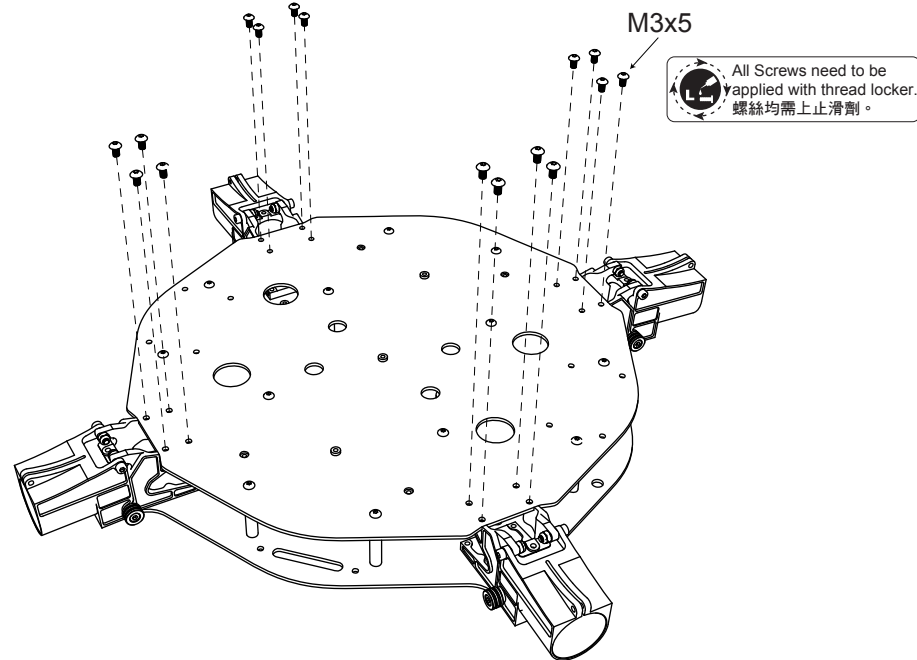

**5** After the boom insert to motor mount, screw the M3x5 first and then tighten M2x8 and M3x8 after.

軸管插入馬達座後，先將M3x5定位螺絲鎖上再鎖緊M2x8及M3x8螺絲。

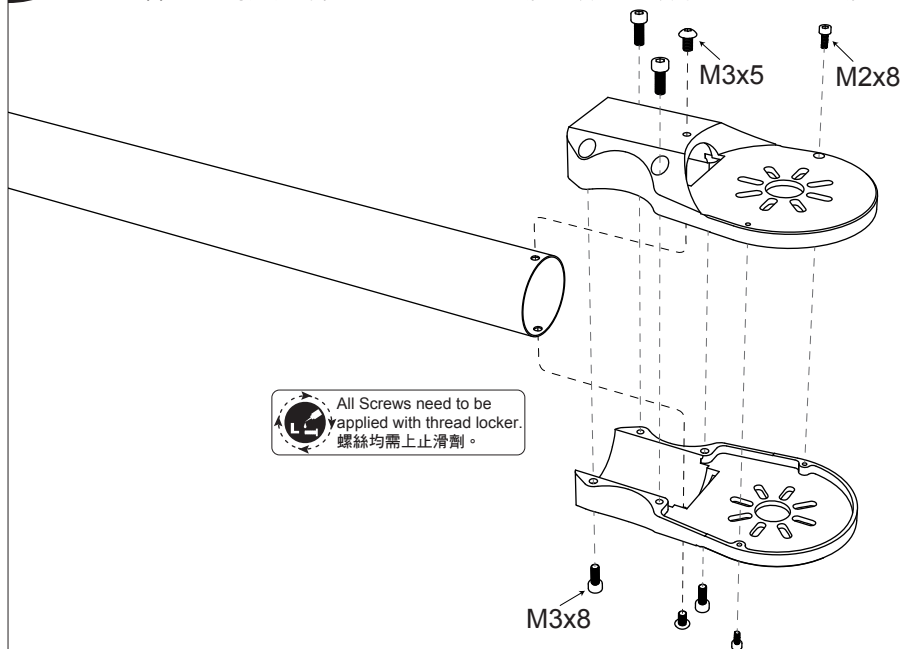

**6** Insert boom to boom mount and screw M3x5 as figure A shows to secure boom position.

Adjust motor mount and body to level then tighten the M3x8 as figure B shows.

將軸管如圖插入定位後鎖上圖A定位螺絲，並把馬達座及機身調整呈水平後鎖緊圖B螺絲。

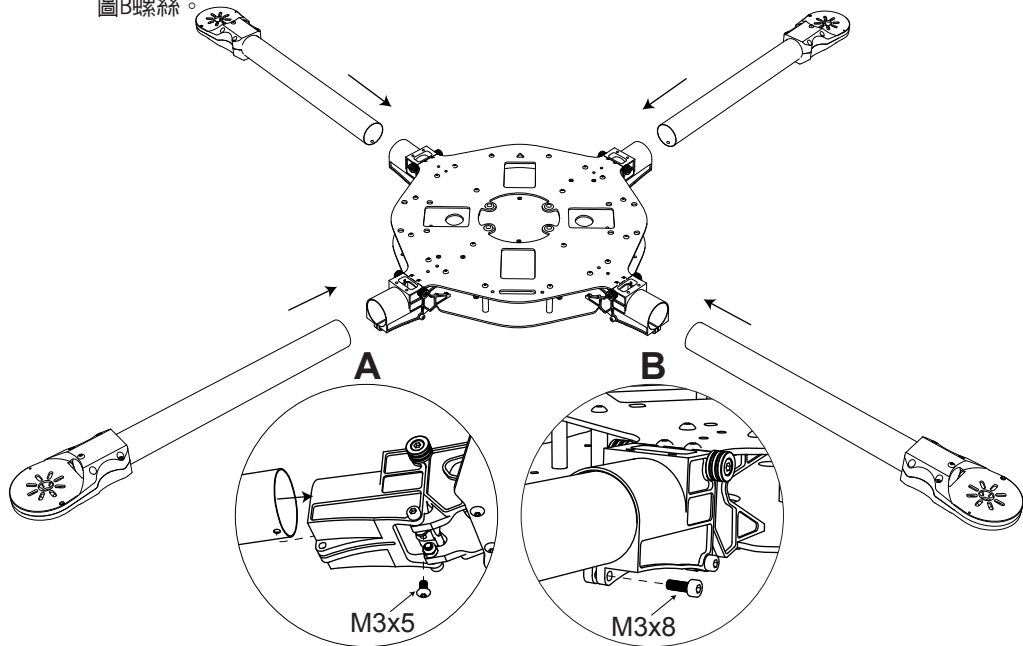

**7** Assemble landing gear boom as figure shows, and install whole landing gear to body frame.

將腳架T管組裝完成後，再將電動收腳如下圖組裝至機身。

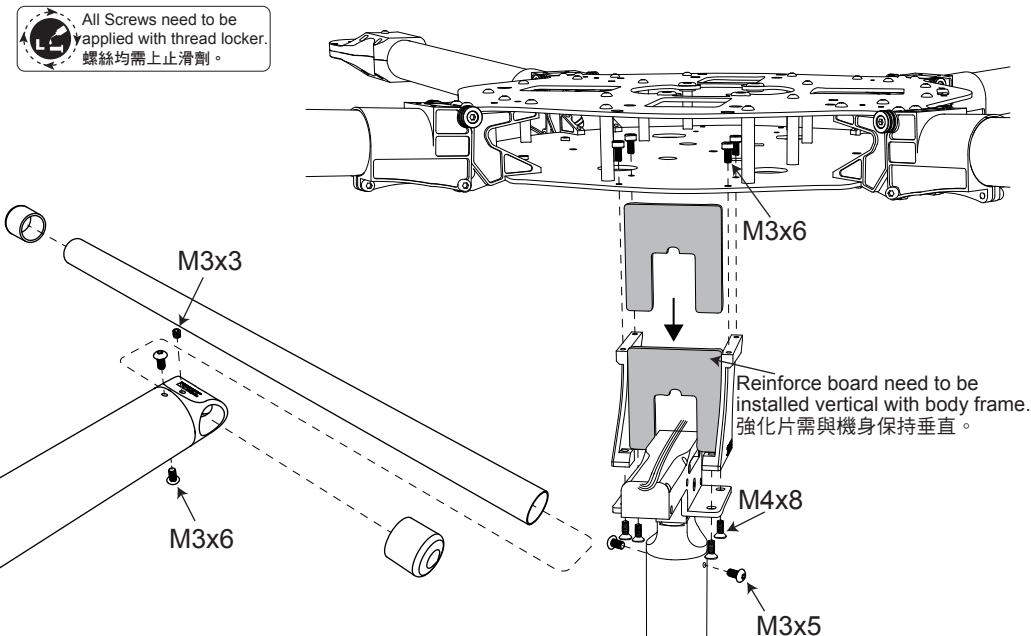

**8** Connect two landing gear wires with Y connector, then connect Y connector to BEC and receiver as picture shows. Please choose proper channel when connect the Y connector and receiver.

將兩組腳架訊號線與Y型線連接，再將Y型線如圖連接於BEC及接收機，連接時請選擇合適的遙控器通道。

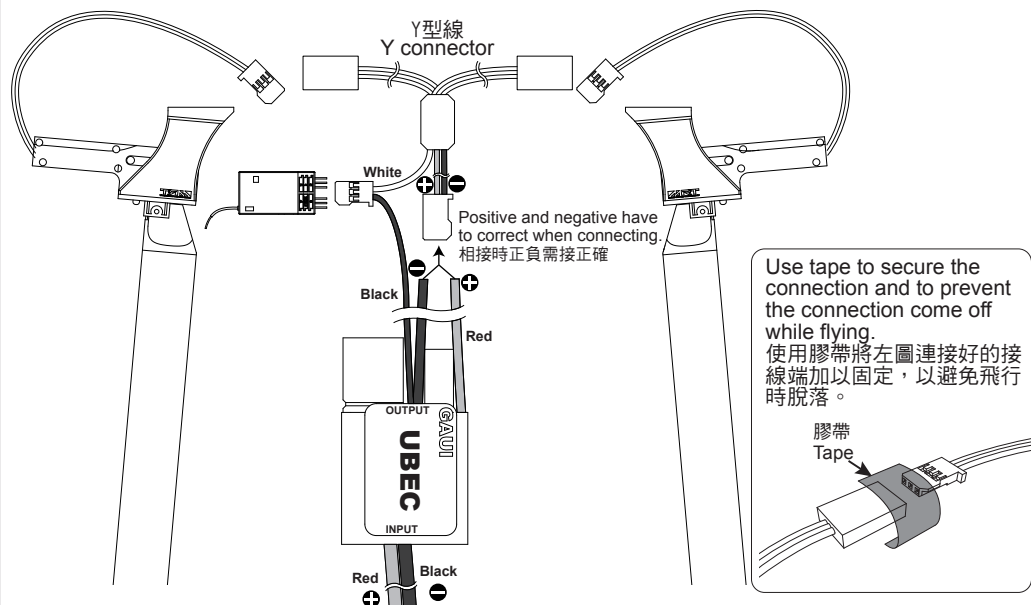

**9**

Please lift the 950Q and test the folding landing gear after complete the installation.

Attention: There is about 1~1.5 second of delay between on/off switch, do not repeat on/off switch operation within short period of time.

安裝完成後請將機體抬離地面並測試收腳是否順暢及有無干涉。  
注意:每次扳動開關後會有1~1.5秒緩衝作動時間,不可連續開關。

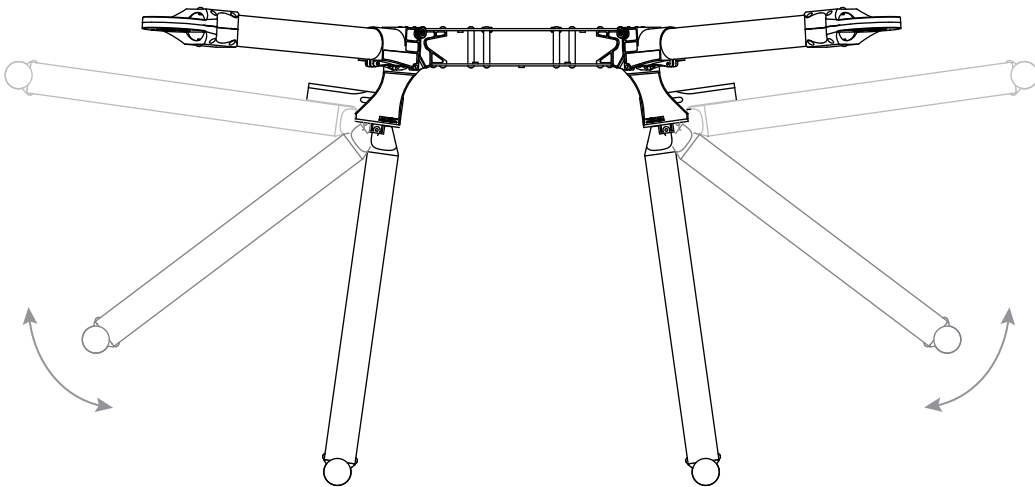
**10**

Power distributor board can be placed in three different positions depend on demand.

可依需求變換分電盤前、中、後三個鎖點位置。

All Screws need to be applied with thread locker.  
螺絲均需上止滑劑。

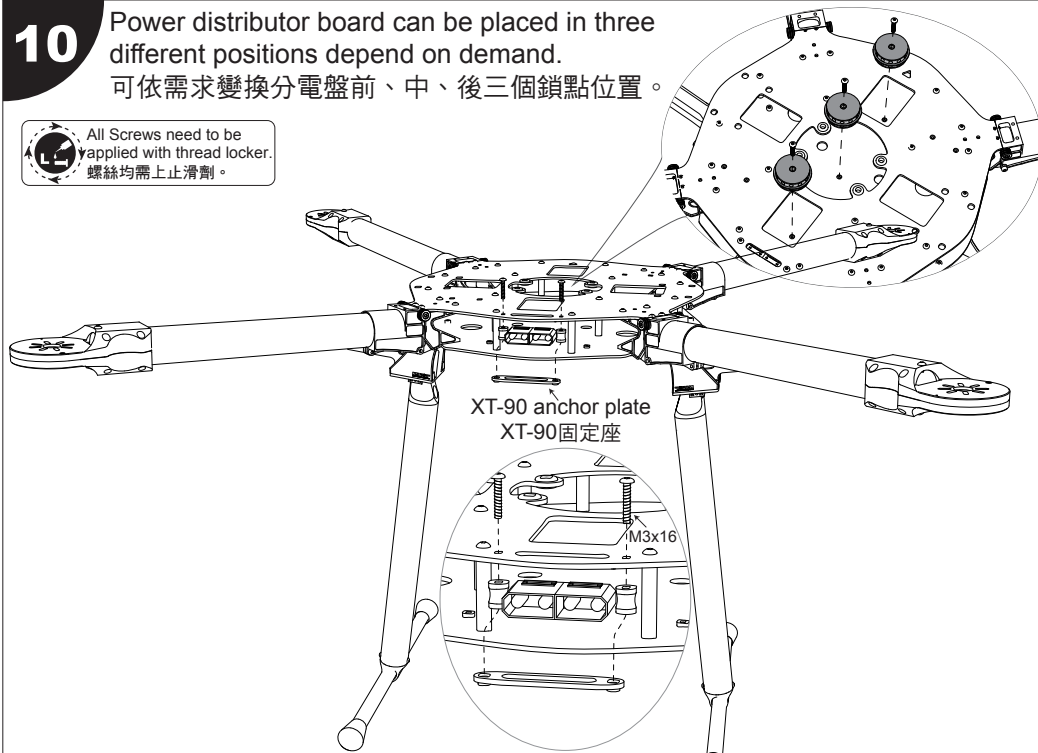
**11**

MRT Sliding Track  
多旋翼雲台滑軌組

1. Install sliding track to the frame as figure shows.

將雲台滑軌座如左圖鎖至機身。

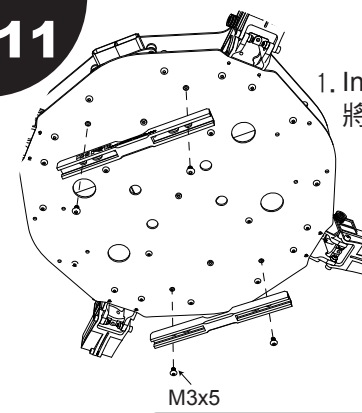

M3x5  
All Screws need to be applied with thread locker.  
螺絲均需上止滑劑。

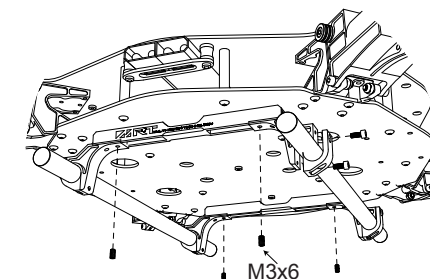

3. Install gimbal hanger and use M3x6 screws to secure it after checking all units are in proper position.

確認位置後裝上雲台吊桿及M3x6止付螺絲定位。

2. Adjust the sliding track to require distance.  
依所需距離調整組裝方式。

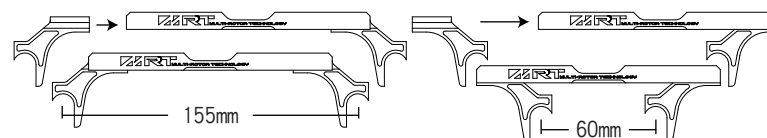
**12**

MRT Shared Battery Tray  
多旋翼共用電池板組

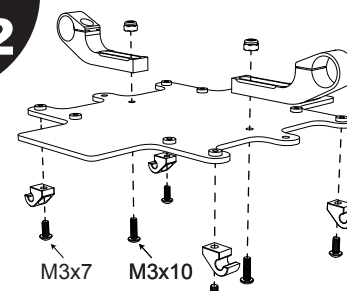

As illustration above, assemble the battery tray.  
將電池板組如上圖組裝。

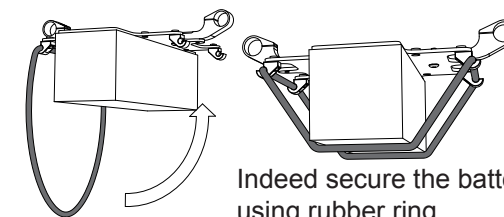

Indeed secure the battery with using rubber ring.  
用電池束環確實將電池固定。

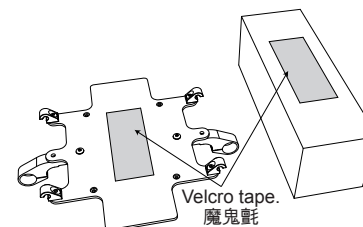

Battery tray and batteries need to stick with Velcro tape.  
電池板與電池需黏上魔鬼氈。

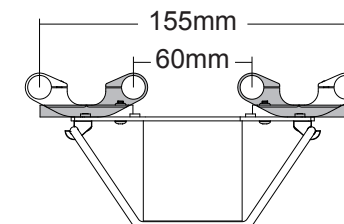

Set the required distance by adjusting battery clamp.  
可依所需距離調整電池管夾。